

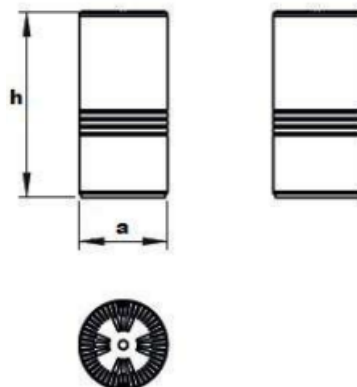

CORP DE ILUMINAT LED EXE-P-SMD-IP40



DATE ELECTRICE

Voltage [V]	220-240
Frecventa [Hz]	50/60
Sursa	LED
Power factor PF	>0.9
CRI [RA]	>80
Optica	15/30/45/60°
Optional	dimabil/kit de emergenta

DATE TEHNICE

Montaj	APLICAT
Material	ALUMINIU
Finisaj	ALB
Factor protectie [IP]	IP40
Factor protectie [IK]	IK09
Temperatura	5°C ... +30°C
Durata medie [h]	60000

MODELE

Cod	Descriere
EXE-P-SMD-21W-IP40	EXE CORP DE ILUMINAT LED 21W, 1910LM, 2700/6500K, D: 118 mm, H: 245 mm, IP40
EXE-P-SMD-28W-IP40	EXE CORP DE ILUMINAT LED 28W, 2870LM, 2700/6500K, D: 118 mm, H: 245 mm, IP40

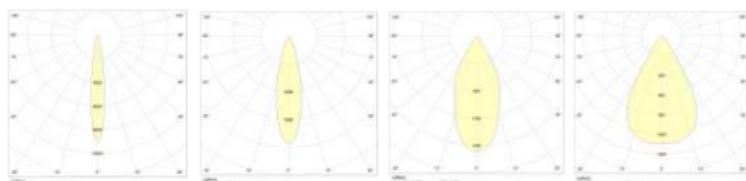

15° Reflector

30° Reflector

45° Reflector

60° Reflector



ISO 9001



ISO 14001



ISO 27001



ISO 45001



ISO 37001



ISO 50001

Romania Office & Production:

Aeroportului no.141 Street, Mogosoaia, Ilfov, PO 077135
www.exeholding.com; office@exeholding.com; Phone: +40 722 241 231