

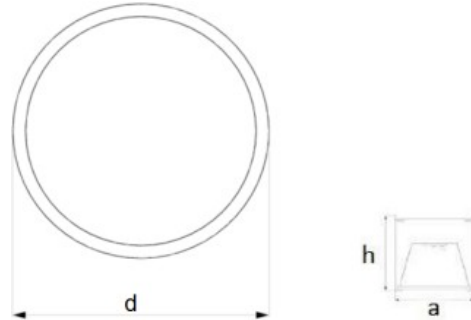

CIRCULAR LED EXE-P-GE-IP40



DATE ELECTRICE

| | |
|-----------------|-----------------------|
| Voltage [V] | 220-240 |
| Frecventa [Hz] | 50/60 |
| Sursa | LED |
| Power factor PF | >0.9 |
| CRI [RA] | >80 |
| Optica | 120° |
| Optional | dimabil/kit emergenta |

DATE TEHNICE

| | |
|-----------------------|---------------|
| Montaj | SUSPENDAT |
| Material | ALUMINIU |
| Finisaj | ALB/NEGRU/RAL |
| Factor protectie [IP] | IP40 |
| Factor protectie [IK] | IK08 |
| Temperatura | 5°C ... +30°C |
| Durata medie [h] | 60000 |

MODELE

| Cod | Descriere |
|----------------------|--|
| EXE-P-GE-39/18W-IP40 | EXE CIRCULAR UP&DOWN LED 39/18W, 3880/1405LM, 2700/6500K, 79X620X73 mm, IP40 |
| EXE-P-GE-53/21W-IP40 | EXE CIRCULAR UP&DOWN LED 53/21W, 5170/1685LM, 2700/6500K, 79X800X73 mm, IP40 |
| EXE-P-GE-66/28W-IP40 | EXE CIRCULAR UP&DOWN LED 66/28W, 6460/2250LM, 2700/6500K, 79X980X73 mm, IP40 |



Romania Office & Production:

Aeroportului no.141 Street, Mogosoaia, Ilfov, PO 077135
www.exeholding.com; office@exeholding.com; Phone: +40 722 241 231



EXE GREEN HOLDING

ENERGY EFFICIENCY SOLUTIONS

| | |
|----------------------|---|
| EXE-P-GE-79/35-IP40 | EXE CIRCULAR UP&DOWN LED 79/35W, 7755/2810LM, 2700/6500K, 79X1155X73 mm, IP40 |
| EXE-P-GE-92/39-IP40 | EXE CIRCULAR UP&DOWN LED 92/39W, 9045/3090LM, 2700/6500K, 79X1335X73 mm, IP40 |
| EXE-P-GE-105/46-IP40 | EXE CIRCULAR UP&DOWN LED 105/46W, 10340/3650LM, 2700/6500K, 79X1500X73 mm, IP40 |
| EXE-P-GE-132/57-IP40 | EXE CIRCULAR UP&DOWN LED 132/57W, 13300/4495LM, 2700/6500K, 79X1890X73 mm, IP40 |

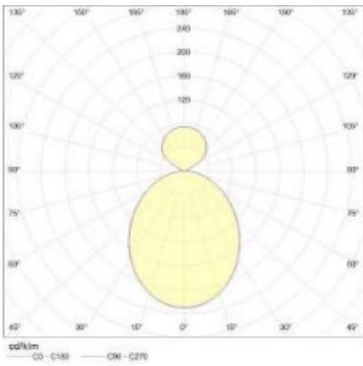

ISO 9001



ISO 14001



ISO 27001



ISO 45001



ISO 37001



ISO 50001

Romania Office & Production:

Aeroportului no.141 Street, Mogosoia, Ilfov, PO 077135

www.exeholding.com; office@exeholding.com; Phone: +40 722 241 231