

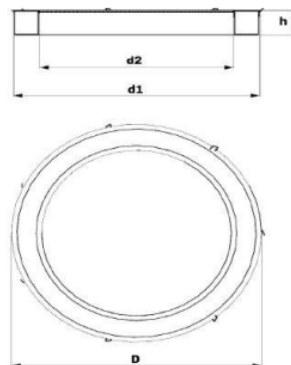

CIRCULAR LED EXE-P-GOR-IP40



DATE ELECTRICE

Voltage [V]	220-240
Frecventa [Hz]	50/60
Sursa	LED
Power factor PF	>0.9
CRI [RA]	>80
Optica	120°
Optional	dimabil/kit emergenta

DATE TEHNICE

Montaj	INCASTRAT
Material	ALUMINIU
Finisaj	ALB/NEGRU/RAL
Factor protectie [IP]	IP40
Factor protectie [IK]	IK08
Temperatura	5°C ... +30°C
Durata medie [h]	60000

MODELE

Cod	Descriere
EXE-P-GOR-53W-IP40	EXE CIRCULAR LED 53W, 5170LM, 2700/6500K, 820X807X84 mm, IP40
EXE-P-GOR-66W-IP40	EXE CIRCULAR LED 66W, 6460LM, 2700/6500K, 1000X987X84 mm, IP40
EXE-P-GOR-79W-IP40	EXE CIRCULAR LED 79W, 7755LM, 2700/6500K, 1175X1162X84 mm, IP40
EXE-P-GOR-92W-IP40	EXE CIRCULAR LED 92W, 9045LM, 2700/6500K, 1355X1342X84 mm, IP40
EXE-P-GOR-105W-IP40	EXE CIRCULAR LED 105W, 10340LM, 2700/6500K, 1520X1507X84 mm, IP40
EXE-P-GOR-132W-IP40	EXE CIRCULAR LED 132W, 12920LM, 2700/6500K, 1910X1897X84 mm, IP40
EXE-P-GOR-158W-IP40	EXE CIRCULAR LED 158W, 2275LM, 2700/6500K, 2262X2090X84 mm, IP40

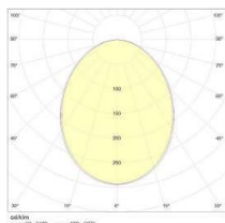

ISO 9001



ISO 14001



ISO 27001



ISO 45001



ISO 37001



ISO 50001

Romania Office & Production:

Aeroportului no.141 Street, Mogosoaia, Ilfov, PO 077135

www.exeholding.com; office@exeholding.com; Phone: +40 722 241 231